



PROJECT		REF		REV	ITEM CODE	
LOCATION		DATE			PAGE	

SANITARY WARE SPECIFICATION SHEET

Item Descriptions	GROHE (Germany) "Atrio" Single-lever M-size basin mixer 1/2" with chrome plated finish; nominated flow rate 4.8 L/min in WELS Grade 1; Registration No. TM 21-0068
Dimensions	L125 x W140 x H234 mm
Model	32043003
Finish / Material	Chrome Plated
Country of origin	Germany
Manufacturer	GROHE Limited
Supplier	Acme Sanitary Ware Co. Ltd
Contact Tel/Fax	(852) 2388-7171 / (852) 2710-8012
E-mail	acme@acmesanitary.com.hk
Website	www.acmesanitary.com.hk

Illustration/ Drawing

Technical drawing showing dimensions: 234, 47, 50, 50°, 7°, 163, Ø50, max. 30, Ø34, 495, 125, Ø63, 32-45, G³/₈, G1¹/₄. A detail view shows a 140mm height and 150° angle.

Water Efficiency Label: 4.8 L/min, Grade 1

GROHE StarLight®

GROHE EcoJoy™

GROHE SilkMove®

Product Descriptions

- monobloc installation
- 28 mm ceramic cartridge with **GROHE SilkMove**
- with temperature limiter
- **GROHE StarLight** chrome finish
- **GROHE EcoJoy** 5.7 l/min laminar mousseur
- swivel tubular C-spout with mousseur
- stop limiter
- Push-open waste set 1 1/4"
- flexible connection hoses

GROHE ATRIO

THE ICON OF ELEGANCE AND PRECISION

Consider the circle. A staple of natural geometry. A pure form at once soothing and dynamic. A visual metaphor for both, completeness and eternity. For its Atrio collection GROHE draws on this most elemental and elegant form to create an iconic object that is built to last.

The Atrio collection means design without restrictions. Each item is available in various finishes and size options to meet all demands of personal taste and different design schemes.



Colour options:

- 003 | StarLight Chrome
- DC3 | SuperSteel
- DA3 | Warm Sunset
- A03 | Hard Graphite
- AL3 | Brushed Hard Graphite
- GL3 | Cool Sunrise
- GN3 | Brushed Cool Sunrise
- DL3 | Brushed Warm Sunset
- BE3 | Polished Nickel
- EN3 | Brushed Nickel

Note: [YouTube \(GROHE Atrio Product\) https://www.youtube.com/watch?v=HJDtY_EFMdM](https://www.youtube.com/watch?v=HJDtY_EFMdM)

* All information of the above is for the reference only. No prior notice is made if any changes.



PROJECT		REF		REV	ITEM CODE	
LOCATION		DATE			PAGE	

SANITARY WARE SPECIFICATION SHEET

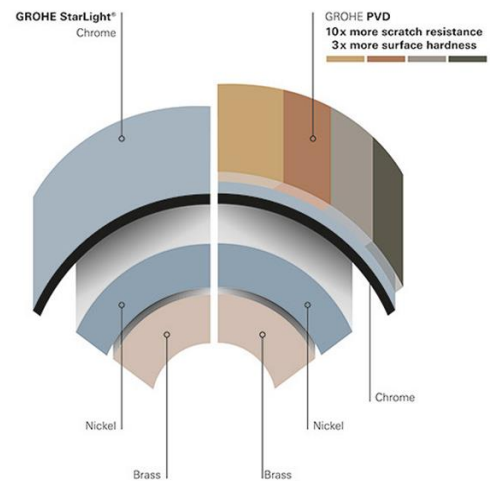

SPARE PARTS

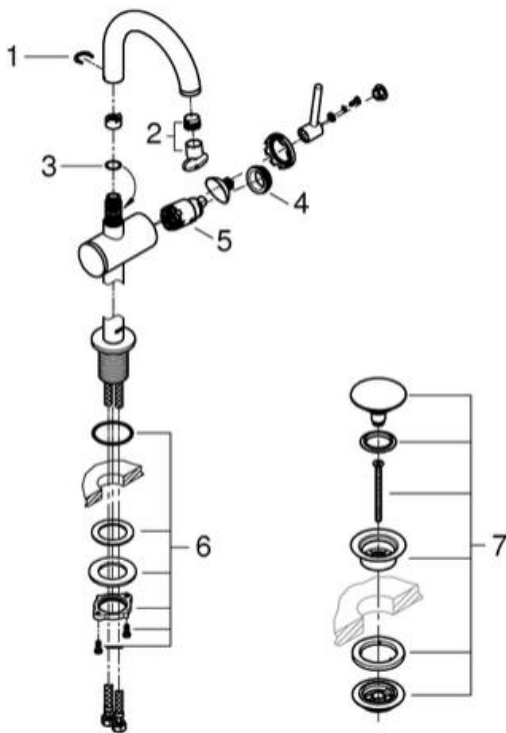

Pos.-nr.	Prod. description	Order-nr.
1	Safety ring	4826600M
2	Laminar flow straightener	48408000
3	Sealing washer Ø 13.5 x Ø 2.75	0128500M
4	Fitting ring	07419000
5	Cartridge	46963000
6	Shank fastening assembly	48384000
7	Waste fitting	65807000

* Optional accessories

Note:

* All information of the above is for the reference only. No prior notice is made if any changes.

註冊號碼 (Registration No.): TM 21-0068



自願參與用水效益標籤計劃 - 水龍頭
Voluntary Water Efficiency Labelling Scheme - Water Taps



茲證明
This is to certify that

將下列水龍頭在本計劃內註冊：
has registered the following water tap under this scheme :

牌子 / Brand : Grohe
型號 / Model : 32043XX3 + 410992031
種類 / Type : Mixing
原產地 / Country or Region Origin : Germany (Mixer & Flow Controller)

XX – denotes the code of colour

在用水效益標籤上展示的標誌
Symbolic Presentation on the Water Efficiency Label :  滴水點
Water droplet(s)

用水效益級別
Water Efficiency Grade : 1

耗水量
Water Consumption : 4.8 公升/分鐘
litres/minute

簽發日期：
Date of Issue: 8 March 2021

 水務署
Water Supplies Department



水務署署長(張業駒代行)
for Director of Water Supplies



水務署
Water Supplies Department

總部 Headquarters

香港灣仔告士打道七號入境事務大樓 48 樓

7 Gloucester Road, Wan Chai, Hong Kong



本署
Our re.
來函檔
Your ref.

21/19 T/J(803/2019)

電話 :
Tel. :
傳真 : 2824 0578
Fax. :

27 December 2019



**Approval of "GROHE" Basin Mixer
(General Acceptance No. C20190629)**

Your letters ref. WRC/2102 and C-WSD/0543 dated 7 August 2019 and 13 December 2019 respectively refer.

Having considered the test report ref. J23941Ar2 issued on 12 September 2019 by Nutek Systems (HK) Ltd., this Authority accepts that the fitting described below complies with, and its use when correctly installed does not contravene, the Waterworks Ordinance and Regulations.

Name of Manufacturer: Grohe AG
Country of Origin: Germany
Brand: Grohe
Details of Fitting: 3/8" Single lever basin mixer
Model: 32043XX3
(where the digits "XX" denote the code of colour)
Body Markings: 
Expiry Date: 31 January 2024



This Authority hereby permits the use of the above fitting in fresh water plumbing systems subject to full adherence to Waterworks installation requirements. In particular, you are required to draw your customers' attention to the following requirement-

"The cold water supply to the fitting shall be drawn from the same source that supplies the hot water apparatus so as to provide a balanced pressure and to obviate the risk of scalding in the event of a restriction or failure in the water supply."

A condition of this acceptance is that the fitting to be installed shall be replicas of the sample as certified by the testing agent mentioned above and without modifications. This acceptance may be withdrawn at any time if the standard of the fitting installed fails to meet that of the approved sample or if the fitting is found to be unsuitable for use in fresh water plumbing systems.

This acceptance is only applicable to the main body of the fitting, unless otherwise specified.

For the use of the fitting in any project, the General Acceptance Number of this letter must be quoted as a means of identification of acceptance of the fitting by this Authority.

Should you have any enquiries, please contact our Engineer Mr. Terry KUNG at tel. no. 3583 4086.

Yours faithfully,

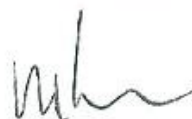

(CHAN Chung-kun)

for Director of Water Supplies

Encl.

c.c. WSD 3321/1/82] - without catalogue
ME/MC] - with soft copy only